

Course & Distance

N. 27 E.	150 1/4 post
S. 42 E.	35 - post
S. 25 W.	18 pine
S. 17 E.	60 gum
N. 16 E.	36 gum
S. 69 E.	40 W.O.
N. 43 E.	27 W.O.
S. 72 E.	31 pine
S. 16 W.	8 1/2 B.O.
S. 74 E.	88 1/3 post
S. 41 W.	52 1/2 stones
N. 77 1/2 W.	76 1/2 pine
N. 86 W.	90 pine
S. 47 1/2 W.	68 post
N. 49 W.	61 1/4 post

The place of beginning

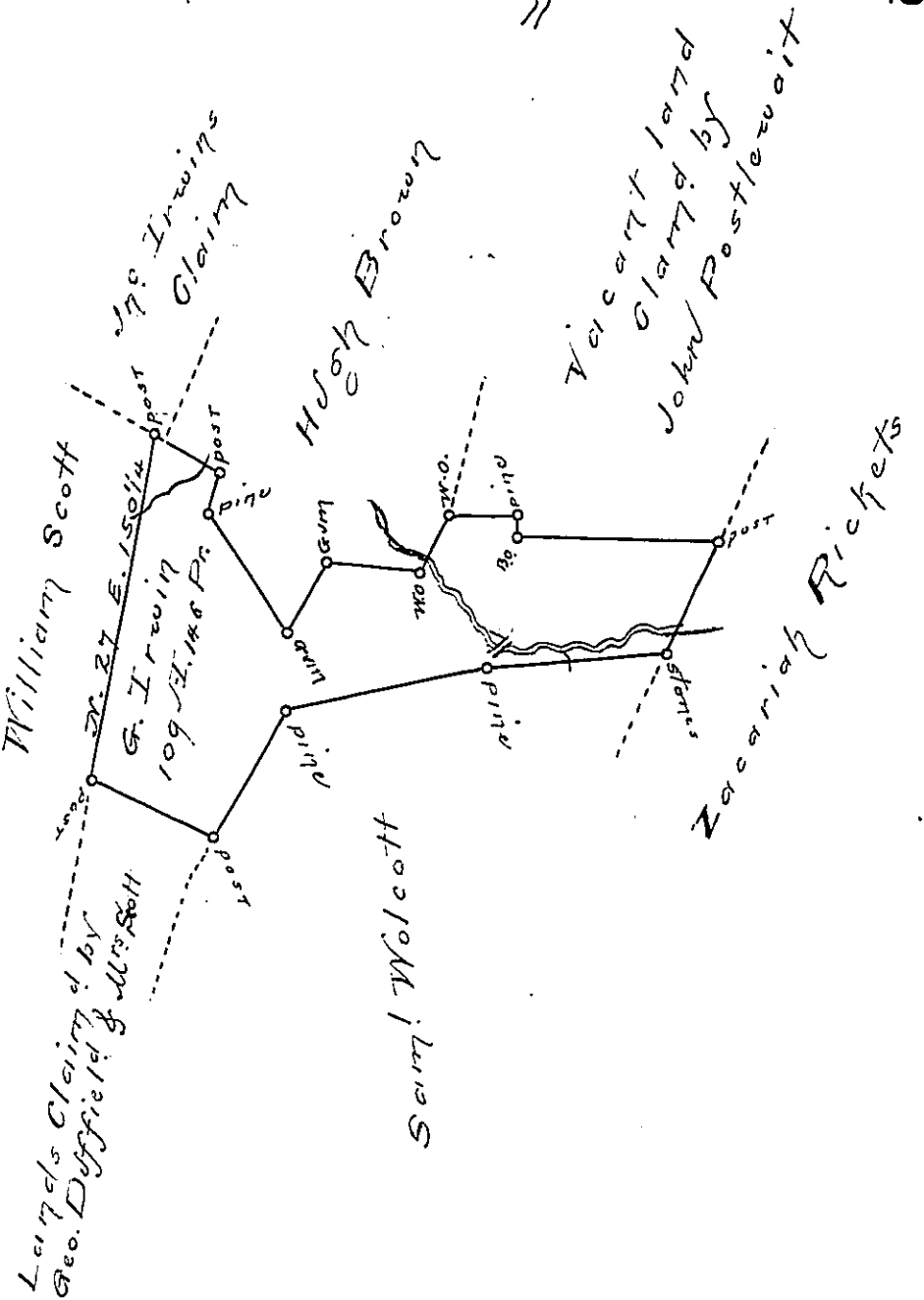

Draught of a Tract of Land Situate in the Longhollow Wayne Township (formerly Cumberland) now Mifflin County containing One Hundred and nine Acres and 146 perches and the allowance of Six P<sup>ts</sup> Cent for Roads &c. Surveyed the 1<sup>st</sup> day of September 1802 agreeable to the lines of the adjacent Survey Intereuance of a Warrant Granted to George Irwin of the County of York Dated the 3<sup>d</sup> day of March 1743.

Note: An Application for 200 Acres in the name of Thomas Seal N<sup>o</sup> 2108 bearing date the 5<sup>th</sup> Dec<sup>r</sup> 1766 appears to call for the above Described Land. I am not certain whether said App<sup>n</sup> has ever been act<sup>d</sup> upon nor do I know the owner

To }  
 Samuel Cochran Esquire } J. William Harris S.  
 Suror. Genl. Pennsylvania }

IN TESTIMONY that the above is a copy of the original remaining on file in the Department of Internal Affairs of Pennsylvania, made conformably to an Act of Assembly approved the 16th day of February, 1833, I have hereunto set my Hand and caused the Seal of said Department to be affixed at Harrisburg, this

— seventh — day of — April — 1896.

James W. Little  
 Secretary of Internal Affairs.